

A Division of ImperialDade

# Floor Mat Placement Guide

Purchasing a matting system is a long-term, cost-effective solution for your facility's everyday needs. This placement guide will help you decide which mats will be the best fit for your facility.

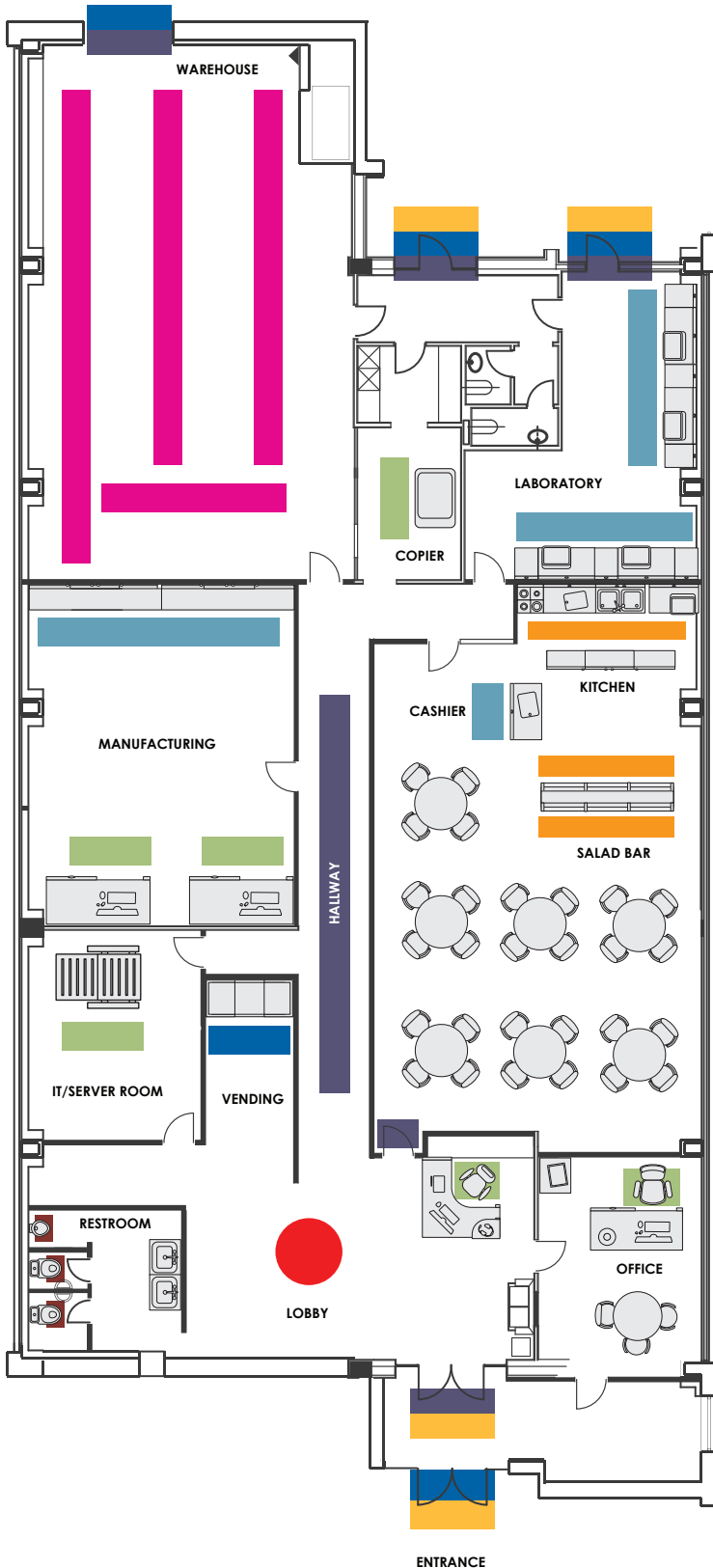

- **Scraper Mat** – Used outside facility entrances to stop mud and large particles from entering the building.
- **Scraper/Wiper Mat** – Placed inside the entrance to provide scraping and wiping action to further remove dirt and moisture.
- **Wiper Mat** – The final mat in a 3 Mat System removes any remaining dust and moisture after using the Scraper and Scraper/Wiper mats.
- **Slip Resistant/Safety Mat** – Protects against slips and falls by creating safe working areas for employees and visitors.
- **Anti-Fatigue Mat** – Enhances worker productivity by providing support for legs and back, allowing your employees to feel comfortable and rested.
- **Anti-Static Mat** - Helps control electrostatic discharge to protect electronic components from damage and data loss.
- **Flow Through Mat** - A wet area solution that allows liquids to pass through to eliminate slip hazards and provide comfort when standing for long periods of time.
- **Restroom Mat** – Extends the life of your restroom floors by soaking up splashes and odors caused by urinal and commode use.
- **Custom Logo Mat** – A unique way to promote your company's image, logos or other designs can be replicated on the face of numerous styles of mats.

**Call 800.251.2437  
or visit [ShopAPT.com](http://ShopAPT.com).**

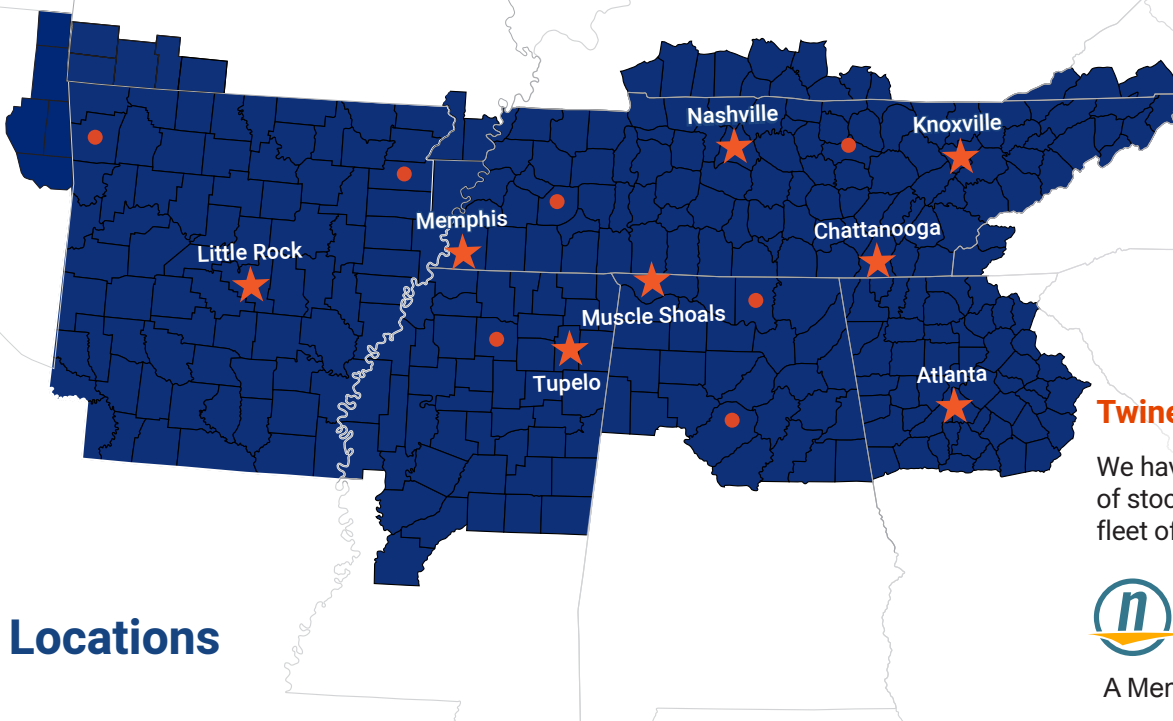

## Locations

### Twiners Deliver™

We have over 625,000 square feet of stocked warehouse space and a fleet of 100+ trucks ready to deliver.



A Member of Network Distribution®

### ★ Full-Service Distribution Centers

**Nashville:**  
7400 Cockrill Bend Blvd.  
Nashville, TN 37209  
O: 615.350.9000

**Knoxville:**  
2710 Redfern Lane  
Knoxville, TN 37931  
O: 865.330.8800

**Little Rock:**  
11611 Otter Creek S. Rd.  
Mabelvale, AR 72103  
O: 501.224.1555

**Muscle Shoals:**  
322 Bob Riley Drive  
Muscle Shoals, AL 35661  
O: 256.383.3912

**Memphis:**  
3695 Knight Road  
Memphis, TN 38118  
O: 901.542.0090

**Chattanooga:**  
2134 Amnicola Hwy.  
Chattanooga, TN 37406  
O: 423.622.8008

**Atlanta:**  
8080 Troon Circle #150  
Austell, GA 30168  
O: 678.398.5701

**Tupelo:**  
127A Godfrey Road #1  
Verona, MS 38879  
O: 662.842.7407

### ● Additional Sales Offices

**Cookeville, TN**  
TF: 800.251.2437

**Birmingham, AL**  
TF: 800.445.7490

**Jonesboro, AR**  
TF: 866.750.1101

**Oxford, MS**  
TF: 866.969.1101

**Jackson, TN**  
TF: 800.969.1101

**Huntsville, AL**  
TF: 800.445.7490

**Rogers, AR**  
TF: 866.750.1101

#### JANITORIAL

#### PACKAGING

#### OFFICE PRODUCTS

#### FOOD SERVICE

#### SAFETY & MORE



It's twine time.™

A Division of ImperialDade

Call 800.251.2437  
or visit ShopAPT.com.

